



Norman Grove, London, E3

BUTLER  STAG





**Immaculate three bedroom Victorian house set within this delightful conservation area in the heart of Bow, just south of Roman Road and Victoria Park, viewings taking place 21st May please book.**



- Stunning Freehold House
- Beautiful West Facing Rear Garden
- Stunning Family Bathroom
- Period Home
- Viewings 21st May please book
- Three Double Bedrooms
- Period Features with Modern Finish
- Available from end of June
- Great Location

Enviably located on this beautiful residential street in the heart of Bow, this well presented 3 bedroom Period Home which offers modern décor and excellent living space with 2 reception rooms one of which could be a double 3rd bedroom, the property also benefits from a private rear garden.

Norman Grove is ideally located close to a good selection of local amenities with Roman Road Market being close by. There is easy access to a broader range of shops found in Stratford and Canary Wharf.

Available from the end of June, this is a property not to miss out on. Viewings taking place on 21st May please book.









## Norman Grove, E3



### Ground Floor

Approx. 55.55 Sq. meters (598 Sq. feet)



### First Floor

Approx. 41.81 Sq. meters (450 Sq. feet)

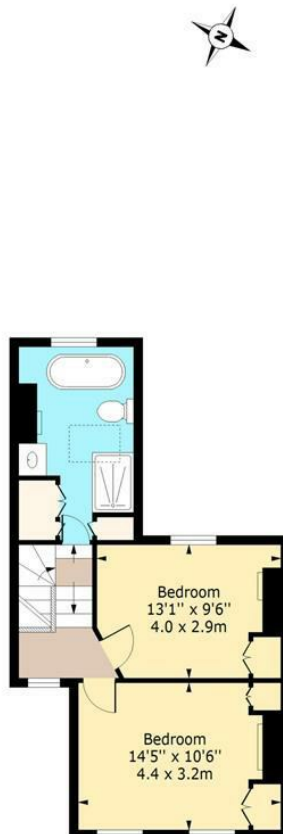

Total area: approx. 97.36 Sq. meters (1048 Sq. feet)  
For illustration purposes only - not to scale  
[www.londonpropertyassessments.co.uk](http://www.londonpropertyassessments.co.uk)

# BUTLER & STAG

☎ 020 8102 1236

🏠 508 Roman Road, Bow, London, E3 5LU

✉ [bow@butlerandstag.com](mailto:bow@butlerandstag.com)

[www.butlerandstag.uk](http://www.butlerandstag.uk)

IMPORTANT NOTICE - These particulars have been prepared in good faith and they are not intended to constitute part of an offer or contract. We have not performed a structural survey on this property and the services, appliances and specific fittings have not been tested. All photographs, measurements, floor plans and distances referred to are given as a guide and should not be relied upon.